



Linksys SE1500, SE2500, SE2800

Ethernet Switches

User Guide

- | | | | | | |
|----|----------------------------|----|------------------------|----|-----------------------|
| EN | User Guide | FI | Käyttöopas | PT | Manual do Utilizador |
| AR | دليل المستخدم | FR | Guide de l'utilisateur | RO | Ghidul utilizatorului |
| BG | Ръководство за потребителя | HU | Felhasználói útmutató | SE | Användarhandbok |
| CZ | Uživatelská příručka | IT | Guida per l'utente | SI | Navodila za uporabo |
| DE | Benutzerhandbuch | NL | Gebruikershandleiding | TH | คู่มือผู้ใช้ |
| DK | Brugervejledning | NO | Brukerhåndbok | TR | Kullanıcı Kılavuzu |
| ES | Guía del usuario | PL | Podręcznik użytkownika | | |

User Guide

- SE2800 8-Port Gigabit Ethernet Switch
- SE2500 5-Port Gigabit Ethernet Switch
- SE1500 5-Port Fast Ethernet Switch

Install Your Switch

1. Connect the power adapter to your electrical socket, then press the power switch on the back of the switch to the  (on) position.

Note: The power switch is not available on switches shipped to Asia, Australia, or New Zealand.

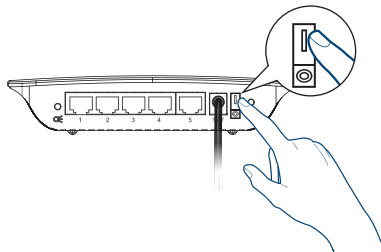
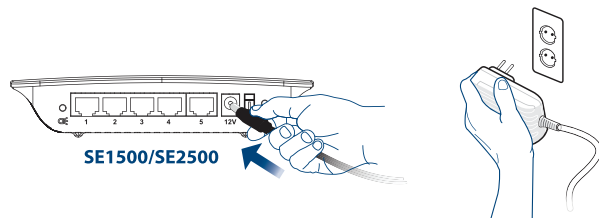

2. Use the blue Ethernet cable provided to connect your router to the switch.

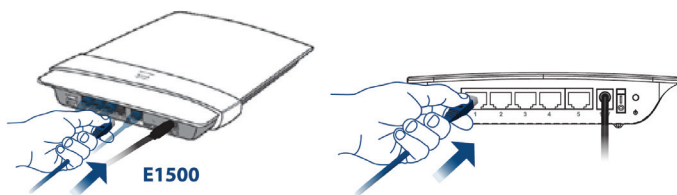

3. Use an Ethernet cable to connect each additional device to your switch.

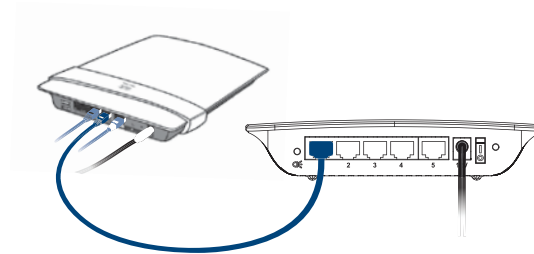

Note: To enable or disable the port status lights, press the  button.

2. استخدم كبل إيثرنت لتوصيل الموجه بالمبدل.

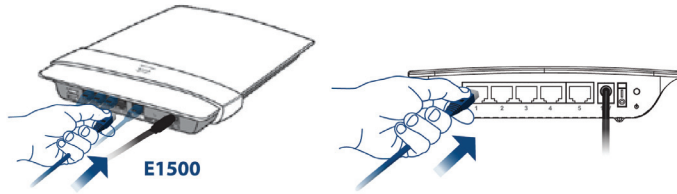

3. استخدم كبل إيثرنت لتوصيل كل جهاز إضافي بالمبدل.

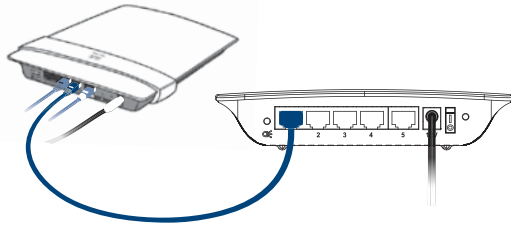

ملاحظة: لتمكين أو تعطيل أضواء حالة المنفذ، اضغط على الزر.

دليل المستخدم

- مبدل إيثرنت غيغابت ذو 8 منافذ SE2800
- مبدل إيثرنت غيغابت ذو 5 منافذ SE2500
- مبدل إيثرنت سريع ذو 5 منافذ SE1500

تركيب المبدل

1. قم بتوصيل محول التيار المتردد بالمبدل وبمأخذ طاقة، ثم اضغط على مبدل الطاقة على الجهة الخلفية من المبدل للانتقال إلى الوضع (تشغيل).

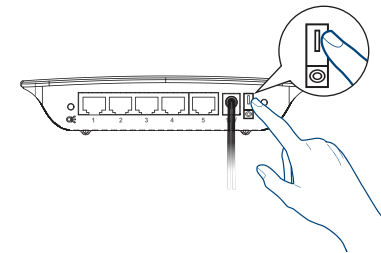
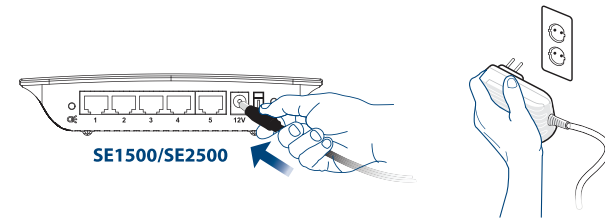

Ръководство за потребителя

- SE2800 8-портов комутатор Gigabit Ethernet
- SE2500 5-портов комутатор Gigabit Ethernet
- SE1500 5-портов комутатор Fast Ethernet

Инсталиране на комутатора

1. Свържете захранващия адаптер към комутатора и контакта, след което натиснете ключа за захранване на гърба на комутатора в положение  (включено).

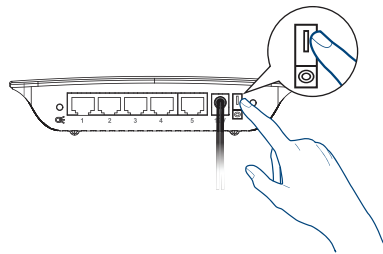
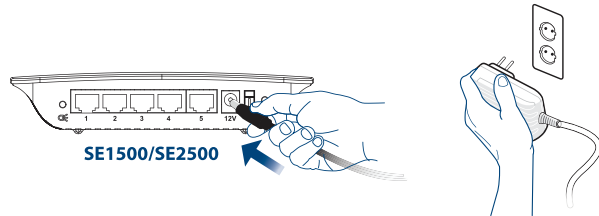

2. Използвайте Ethernet кабел, за да свържете рутера с комутатора.

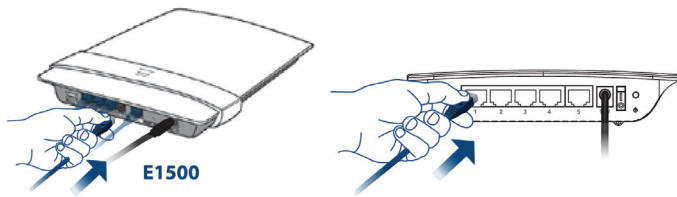

3. Използвайте Ethernet кабел, за да свържете всяко допълнително устройство към комутатора.

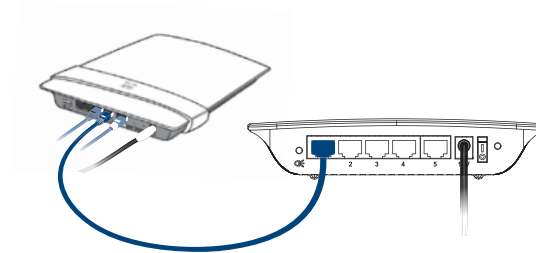

Забележка: За да активирате или деактивирате светлинните индикатори за състояние на портовете, натиснете бутона .

Uživatelská příručka

- 8-portový gigabitový ethernetový přepínač SE2800
- 5-portový gigabitový ethernetový přepínač SE2500
- 5-portový rychlý ethernetový přepínač SE1500

Instalace přepínače

1. Síťový adaptér připojte k přepínači a do síťové zásuvky. Poté stisknutím přepněte vypínač na zadní straně přepínače do polohy  (zapnuto).

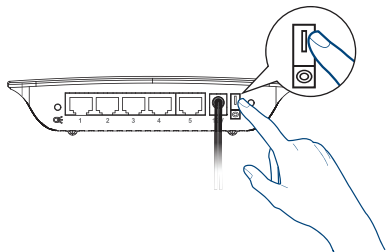
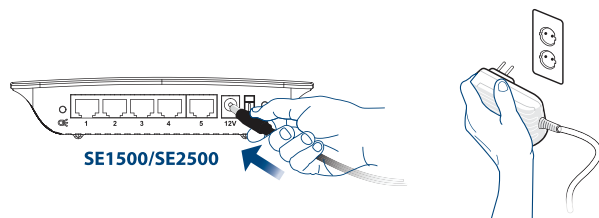

2. Pomocí ethernetového kabelu propojte směrovač a přepínač.

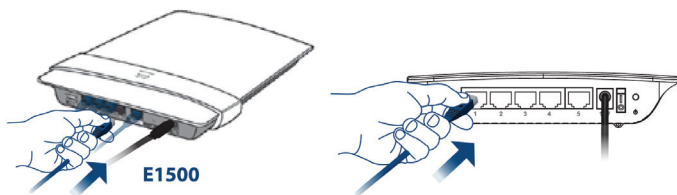

3. Pomocí ethernetového kabelu propojte s přepínačem všechna další zařízení.

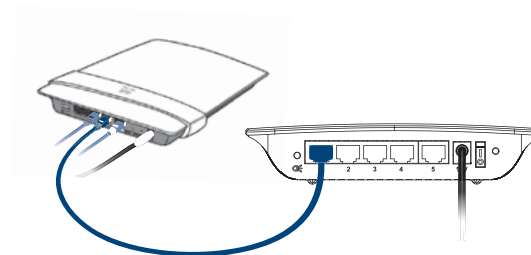

Poznámka: Chcete-li aktivovat nebo vypnout kontrolky stavu portů, stiskněte tlačítko .

Benutzerhandbuch

- SE2800 Gigabit-Ethernet-Switch mit 8 Ports
- SE2500 Gigabit-Ethernet-Switch mit 5 Ports
- SE1500 Fast-Ethernet-Switch mit 5 Ports

Installation des Switches

1. Schließen Sie das Netzteil an den Switch und eine Steckdose an. Drücken Sie die Ein/Aus-Taste auf der Rückseite des Switches, so daß sie auf die Position ON (Ein)  gestellt ist.

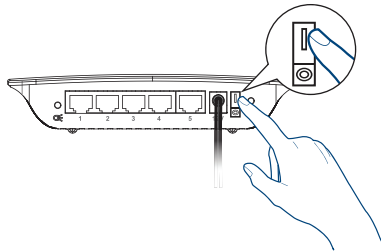
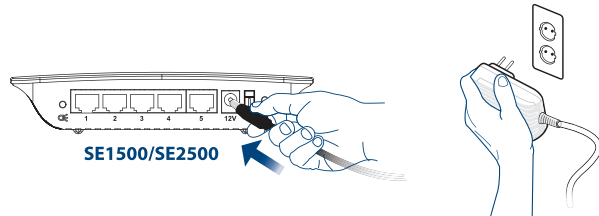

2. Verbinden Sie den Router und den Switch mit einem Ethernet-Kabel.

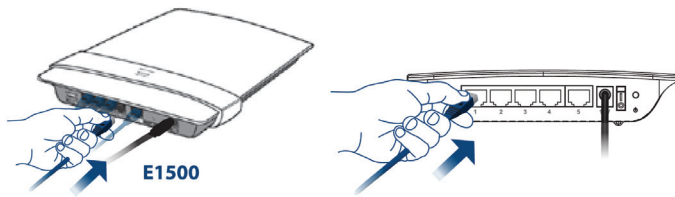

3. Nutzen Sie für den Anschluss weiterer Geräte ebenfalls ein Ethernet-Kabel.

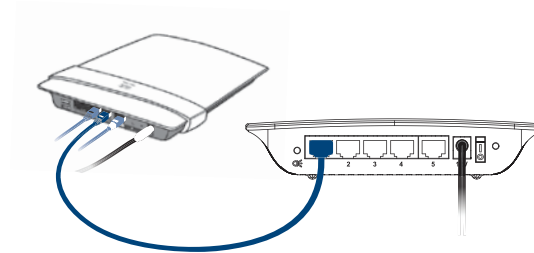

Hinweis: Um die Port-Status-Leuchtanzeige ein- oder auszuschalten, drücken Sie die Taste .

Brugervejledning

- SE2800 Gigabit Ethernet-switch med 8 porte
- SE2500 Gigabit Ethernet-switch med 5 porte
- SE1500 Hurtigt Ethernet-switch med 5 porte

Installer din switch

1. Slut AC-adapteren til switchen og til stikkontakten, og tryk derefter på strømknappen bag på switchen, så den står i positionen  (tændt).

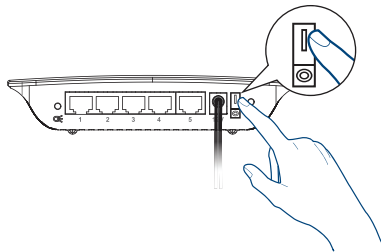
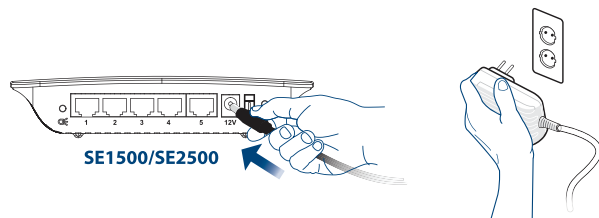

2. Brug Ethernet-kablet til at slutte din router til switchen.

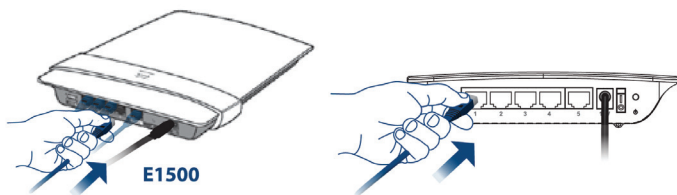

3. Brug Ethernet-kabel til at slutte alle yderligere enheder til din switch.

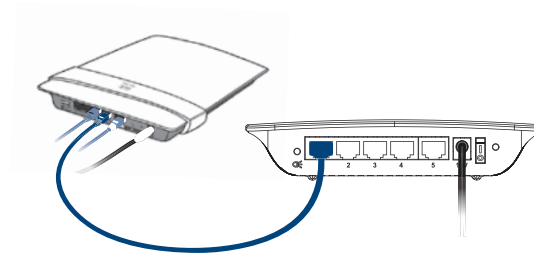

Bemærk: For at aktivere portstatusindikatorerne skal du trykke på knappen .

Guía del usuario

- Switch Gigabit Ethernet de 8 puertos SE2800
- Switch Gigabit Ethernet de 5 puertos SE2500
- Switch Fast Ethernet de 5 puertos SE1500

Instale su switch

1. Conecte el adaptador de CA al switch y a una toma de corriente. A continuación, pulse el interruptor de alimentación situado en la parte posterior del switch y colóquelo en la posición  (encendido).

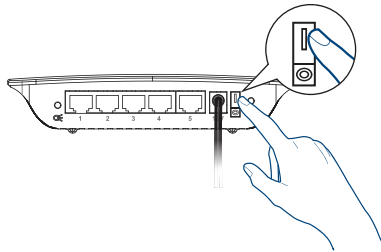
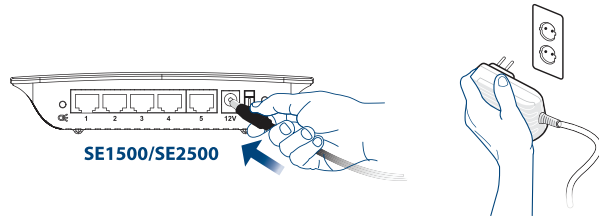

2. Utilice un cable Ethernet para conectar el router al switch.

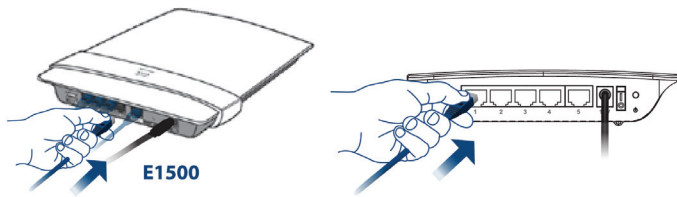

3. Utilice un cable Ethernet para conectar cada dispositivo adicional al switch.

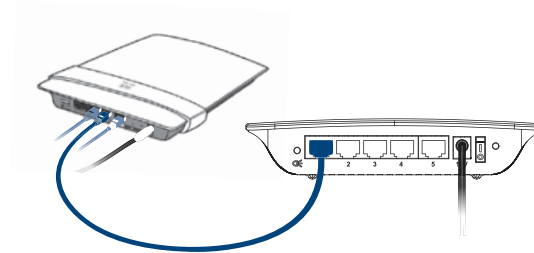

Nota: Para activar o desactivar las luces de estado del puerto, pulse el botón .

Käyttöopas

- 8-porttinen SE2800 Gigabit Ethernet -kytkin
- 5-porttinen SE2500 Gigabit Ethernet -kytkin
- 5-porttinen SE1500 Fast Ethernet -kytkin

Kytkimen asentaminen

1. Liitä virtasovitin kytkimeen ja pistorasiaan. Paina sitten kytkimen takana oleva virtakytkin (on) -asentoon.

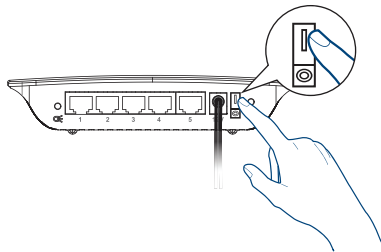
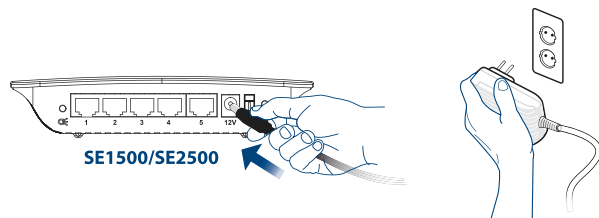

2. Liitä reititin kytkimeen Ethernet-kaapelilla.

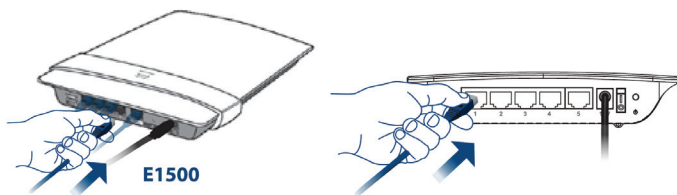

3. Liitä kaikki lisälaitteet kytkimeen Ethernet-kaapeleilla.

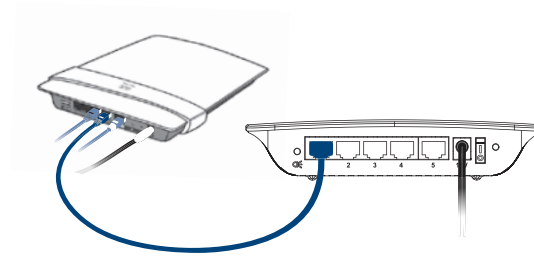

Huomautus: voit ottaa porttien merkkivalot käyttöön tai poistaa ne käytöstä painamalla -painiketta.

Guide de l'utilisateur

- Commutateur Ethernet Gigabit SE2800 8 ports
- Commutateur Ethernet Gigabit SE2500 5 ports
- Commutateur Fast Ethernet SE1500 5 ports

Installez votre commutateur

1. Connectez l'adaptateur secteur au commutateur et à une prise secteur, puis appuyez sur le commutateur d'alimentation derrière l'arrière du commutateur pour le positionner sur  (Marche).

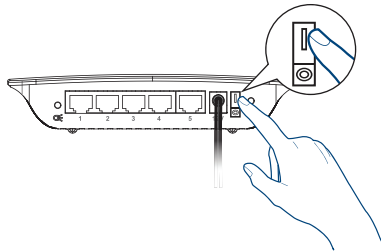
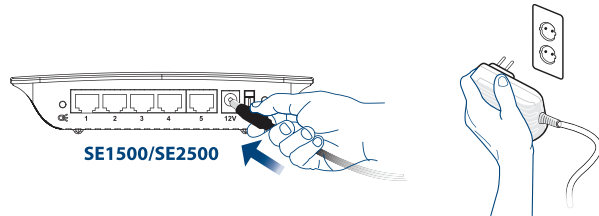

2. Connectez votre routeur au commutateur à l'aide d'un câble Ethernet.

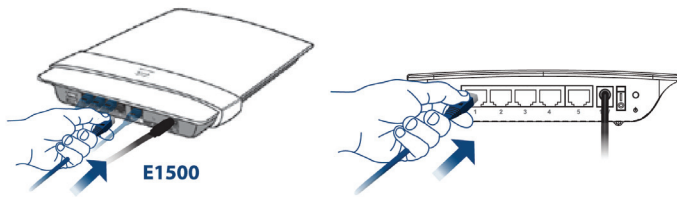

3. Connectez chaque périphérique supplémentaire à votre commutateur à l'aide d'un câble Ethernet.

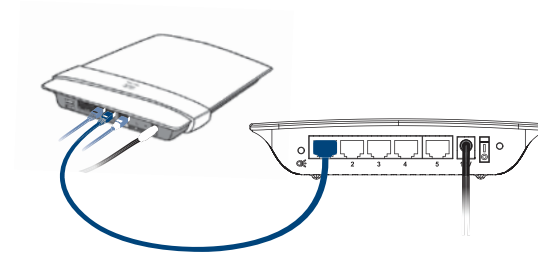

Remarque : Pour activer ou désactiver les voyants d'état du port, appuyez sur le bouton .

Felhasználói útmutató

- SE2800 8 portos Gigabit Ethernet kapcsoló
- SE2500 5 portos Gigabit Ethernet kapcsoló
- SE1500 5 portos Fast Ethernet kapcsoló

A kapcsoló telepítése

1. Csatlakoztassa a hálózati adaptert a kapcsolóhoz és csatlakozóaljzathoz, majd nyomja a kapcsoló hátoldalán található főkapcsolót (be) helyzetbe.

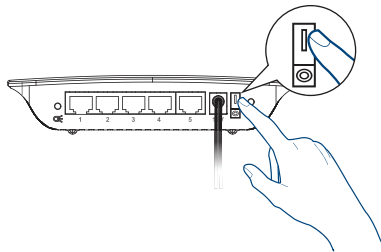
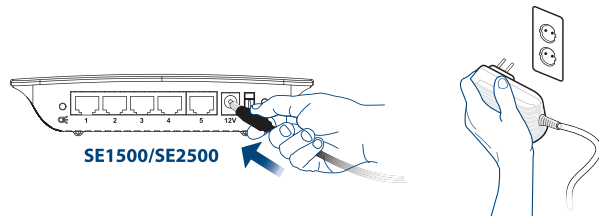

2. Ethernet kábel segítségével csatlakoztassa az útválasztót a kapcsolóhoz.

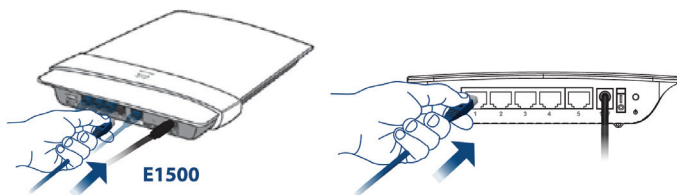

3. Ethernet kábel segítségével csatlakoztassa a további eszközöket a kapcsolóhoz.

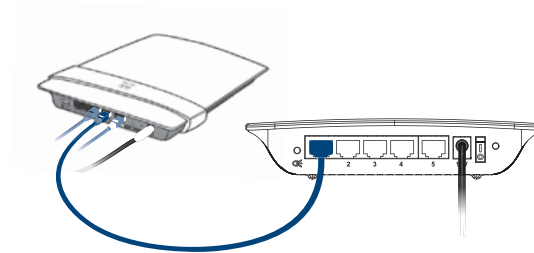

Megjegyzés: A portok állapotjelző fényeinek be- és kikapcsolásához nyomja meg a  gombot.

Guida per l'utente

- Switch Gigabit Ethernet a 8 porte SE2800
- Switch Gigabit Ethernet a 5 porte SE2500
- Switch Fast Ethernet a 5 porte SE1500

Installazione dello switch

1. Connettere l'adattatore CA allo switch e alla presa di corrente, quindi premere l'interruttore di alimentazione sul retro dello switch in posizione  (acceso).

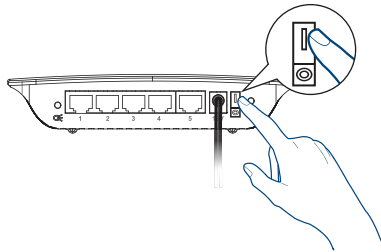
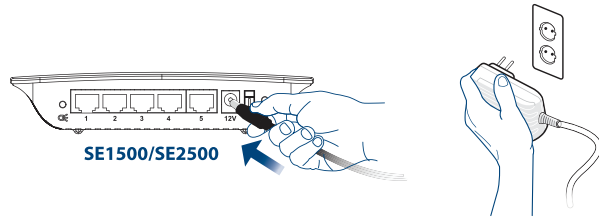

2. Utilizzare un cavo Ethernet per collegare il router allo switch.

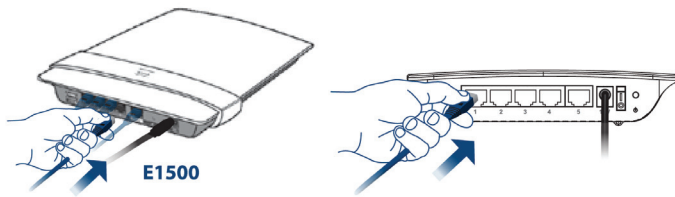

3. Utilizzare un cavo Ethernet per collegare ciascun dispositivo aggiuntivo allo switch.

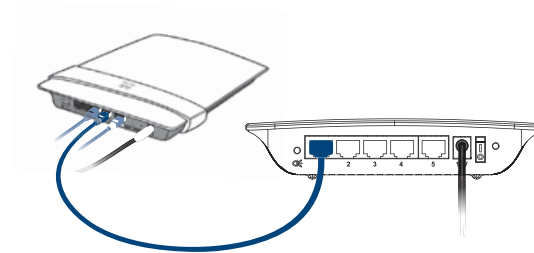

Nota: per attivare o disattivare le spie di stato della porta, premere il pulsante .

Gebruikershandleiding

- SE2800 8-poorts Gigabit Ethernet-switch
- SE2500 5-poorts Gigabit Ethernet-switch
- SE1500 5-poorts Fast Ethernet-switch

Uw switch installeren

1. Sluit de wisselstroomadapter aan op de switch en op een stopcontact. Zet vervolgens de aan-uitknop aan de achterzijde van de switch in de stand  (aan).

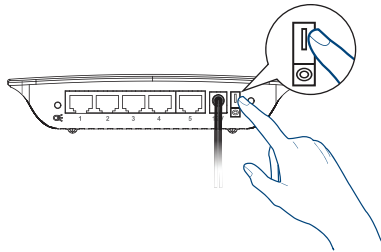
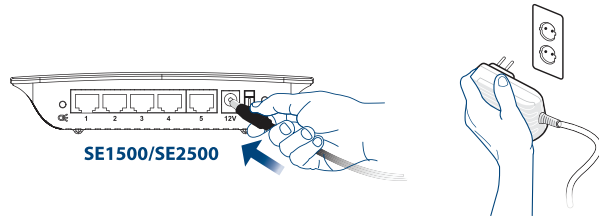

2. Sluit de router aan op de switch met behulp van een Ethernetkabel.

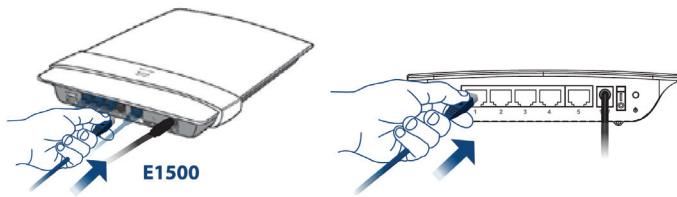

3. Gebruik ook een Ethernetkabel om elk extra apparaat aan te sluiten op uw switch.

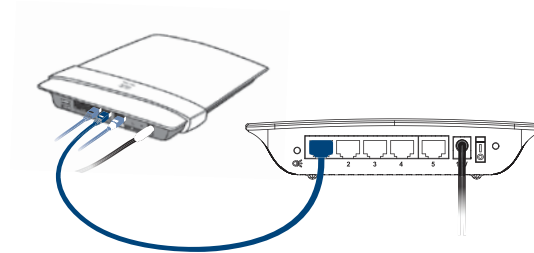

Opmerking: druk op de knop  om de statuslampjes van de poort in of uit te schakelen.

Brukerhåndbok

- SE2800 8-porters Gigabit Ethernet-svitsj
- SE2500 5-porters Gigabit Ethernet-svitsj
- SE1500 5-porters Fast Ethernet-svitsj

Installer svitsjen

1. Koble strømadapteren til svitsjen og et strømuttak, og sett deretter på av-/på-knappen på baksiden av svitsjen i posisjonen  (på).

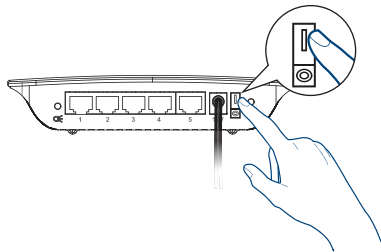
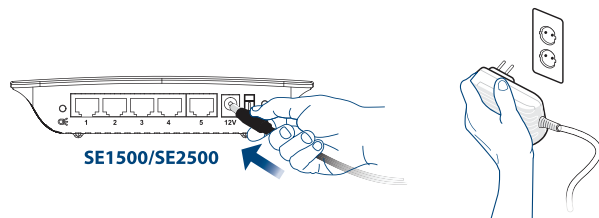

2. Bruk en Ethernet-kabel til å koble ruterer til svitsjen.

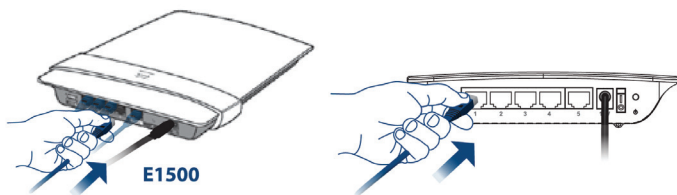

3. Bruk en Ethernet-kabel til å koble hver enkelt tilleggsenhet til svitsjen.

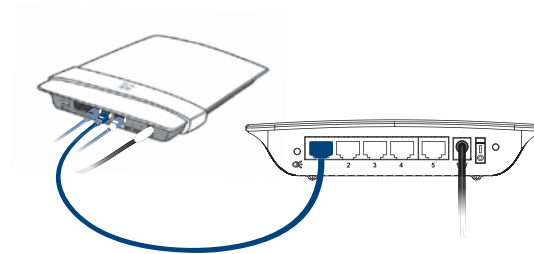

Merk: Hvis du vil aktivere eller deaktivere portstatuslampene, kan du trykke på knappen .

Podręcznik użytkownika

- 8-portowy przełącznik Gigabit Ethernet SE2800
- 5-portowy przełącznik Gigabit Ethernet SE2500
- 5-portowy przełącznik Fast Ethernet SE1500

Instalacja przełącznika

1. Podłącz zasilacz do przełącznika i do gniazda zasilania, a następnie ustaw włącznik zasilania z tyłu przełącznika w pozycji  (włączony).

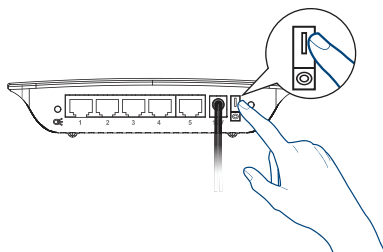
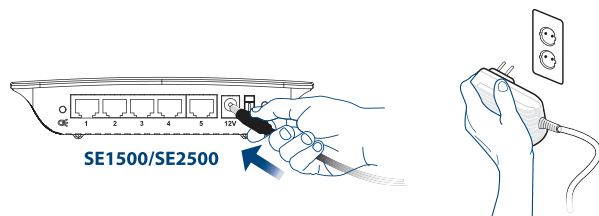

2. Za pomocą kabla Ethernet połącz router z przełącznikiem.

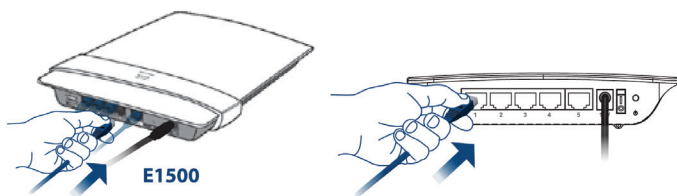

3. Za pomocą kabla Ethernet podłącz każde dodatkowe urządzenie do przełącznika.

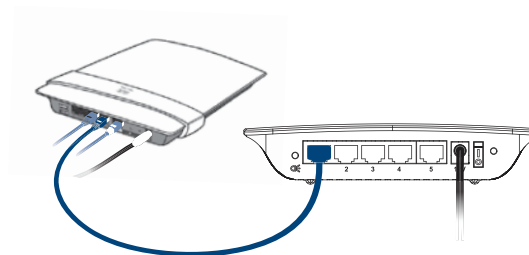

Uwaga: Aby włączyć lub wyłączyć lampki stanu portów, naciśnij przycisk .

Manual do Utilizador

- SE2800 Switch Ethernet Gigabit de 8 portas
- SE2500 Switch Ethernet Gigabit de 5 portas
- SE1500 Switch Fast Ethernet de 5 portas

Instalar o switch

1. Ligue o transformador CA ao switch e a uma tomada eléctrica e, em seguida, prima o interruptor de alimentação na parte de trás do switch para a posição  (ligado).

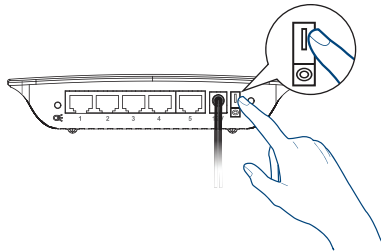
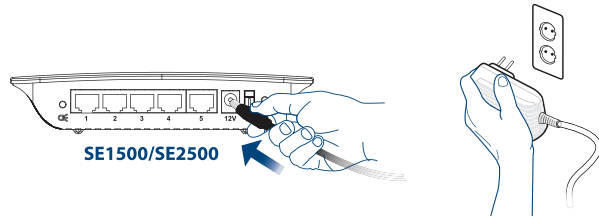

2. Utilize um cabo Ethernet para ligar o seu router ao switch.

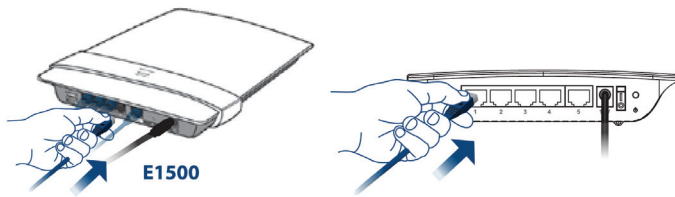

3. Utilize um cabo Ethernet para ligar cada dispositivo adicional ao switch.

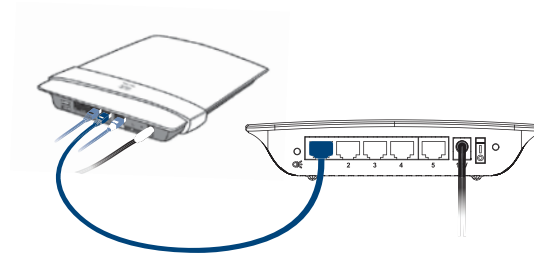

Nota: para activar ou desactivar as luzes de estado da porta, prima o botão .

Ghidul utilizatorului

- Switch Gigabit Ethernet cu 8 porturi SE2800
- Switch Gigabit Ethernet cu 5 porturi SE2500
- Switch Fast Ethernet cu 5 poturi SE1500

Instalarea switchului

1. Conectați adaptorul c.a. la switch și la o priză electrică, apoi apăsați comutatorul de alimentare din partea din spate a switchului în poziția  (pornit).

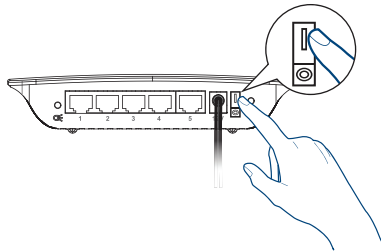
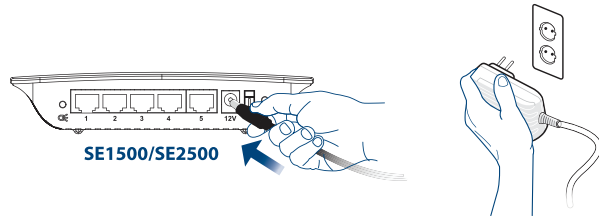

2. Utilizați un cablu Ethernet pentru a conecta routerul la switch.

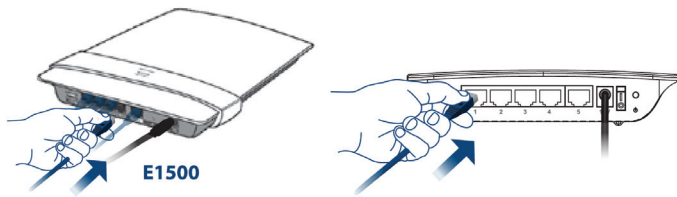

3. Utilizați un cablu Ethernet pentru a conecta fiecare dispozitiv suplimentar la switch.

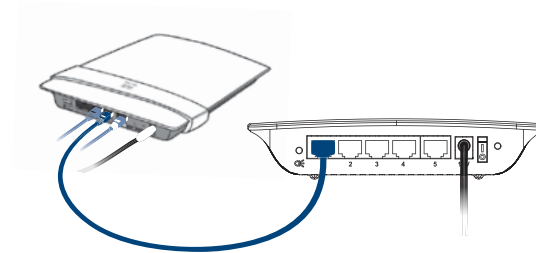

Notă: Pentru a activa sau dezactiva ledurile de stare ale porturilor, apăsați butonul .

Användarhandbok

- Gigabit Ethernet-switch med 8 portar: SE2800
- Gigabit Ethernet-switch med 5 portar: SE2500
- Fast Ethernet-switch med 5 portar: SE1500

Installera switchen

1. Anslut nätadaptern till switchen och till ett eluttag. Tryck därefter strömbrytaren på baksidan av switchen till läget  (på).

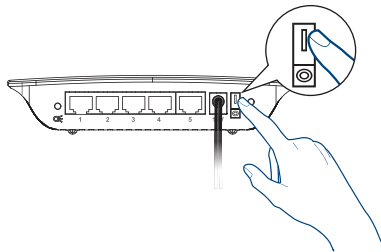
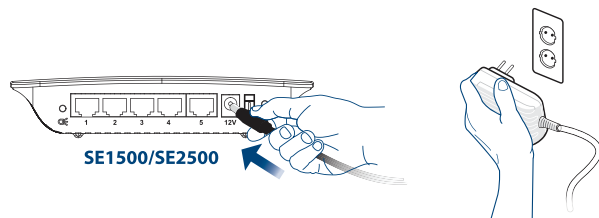

2. Anslut routern till switchen med en Ethernet-kabel.

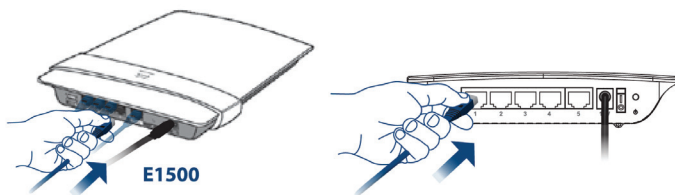

3. Anslut varje ny enhet till switchen med en Ethernet-kabel.

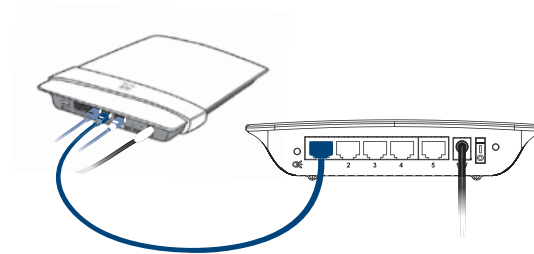

Obs! Tryck på knappen  om du vill aktivera eller avaktivera portstatuslamporna.

Navodila za uporabo

- 8-vratno gigabitno ethernetno stikalo SE2800
- 5-vratno gigabitno ethernetno stikalo SE2500
- 5-vratno hitro ethernetno stikalo SE2500

Namestitev stikala

1. Napajalnik priklopite v stikalo in električno vtičnico, nato pa gumb za vklop na zadnji strani stikala preklopite v položaj  (vklop).

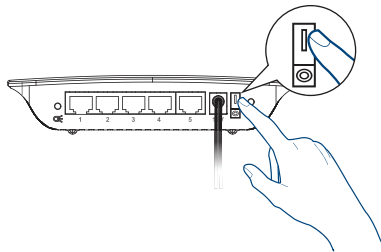
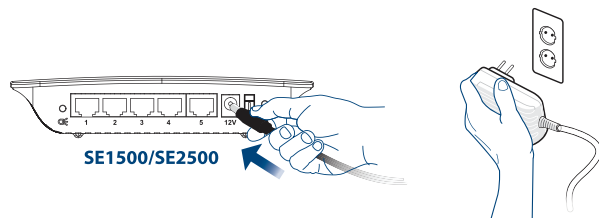

2. Za povezavo usmerjevalnika s stikalom uporabite ethernetni kabel.

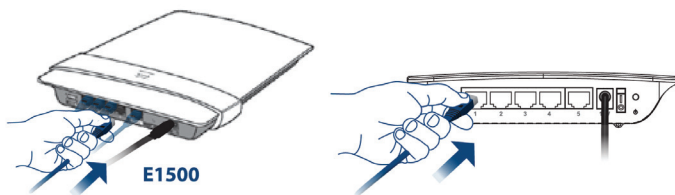

3. Za povezavo vsake dodatne naprave s stikalom uporabite ethernetni kabel.

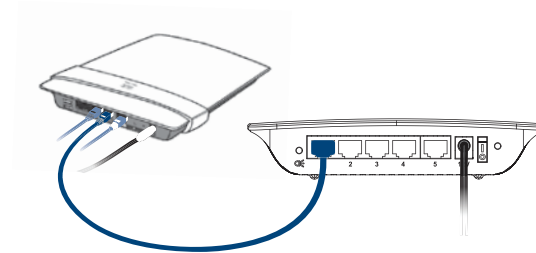

Opomba: če želite omogočiti ali onemogočiti lučke stanj vrat, pritisnite gumb .

คู่มือผู้ใช้

- สวิตช์ Gigabit Ethernet แบบ 8 พอร์ต SE2800
- สวิตช์ Gigabit Ethernet แบบ 5 พอร์ต SE2500
- สวิตช์อีเธอร์เน็ตความเร็วสูง แบบ 5 พอร์ต SE1500

ติดตั้งสวิตช์ของคุณ

1. เชื่อมต่ออะแดปเตอร์ AC เข้ากับสวิตช์และเต้าเสียบ

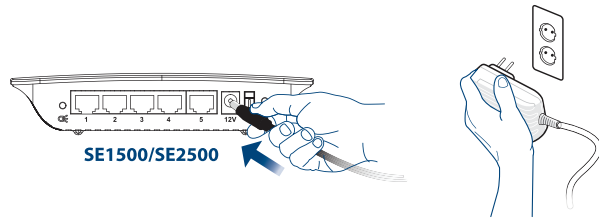

2. ใช้สายเคเบิลอีเธอร์เน็ตในการเชื่อมต่อเราเตอร์ของคุณเข้ากับสวิตช์

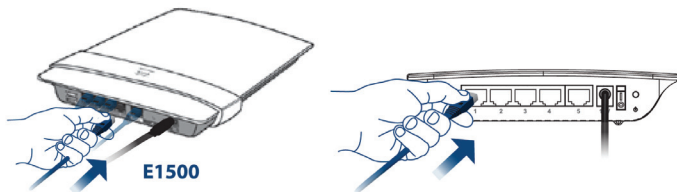

3. ใช้สายเคเบิลอีเธอร์เน็ตในการเชื่อมต่ออุปกรณ์เสริมแต่ละอันของคุณกับสวิตช์

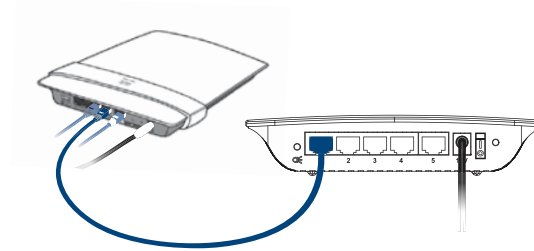

หมายเหตุ: หากต้องการใช้งานหรือหยุดใช้งานไฟสถานะของพอร์ต ให้กดปุ่ม .

Kullanıcı Kılavuzu

- SE2800 8-Portlu Gigabit Ethernet Switch
- SE2500 5-Portlu Gigabit Ethernet Switch
- SE1500 5-Portlu Fast Ethernet Switch

Switch'inizi Kurun

1. AC adaptörünü switch'e ve bir elektrik prizine bağlayın ve ardından switch'in arkasındaki güç anahtarına basarak  (açık) konumuna getirin.

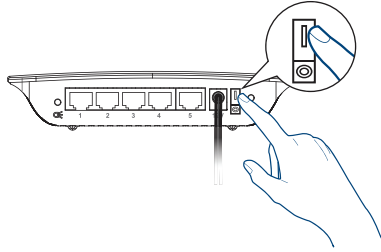
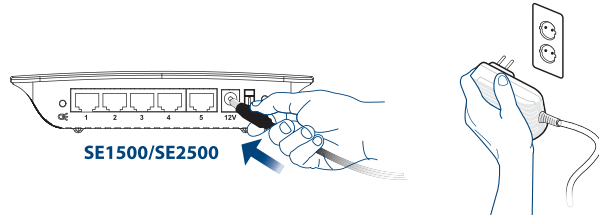

2. Router'ınızı switch'e bağlamak için bir Ethernet kablosu kullanın.

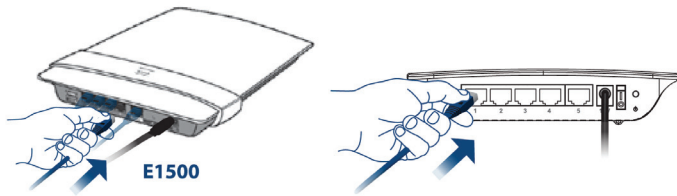

3. Switch'inize her yeni aygıtı bağlamak için bir Ethernet kablosu kullanın.

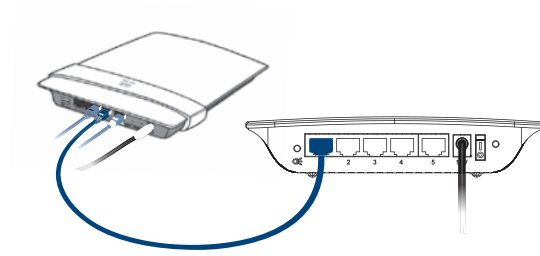

Not: Port durum ışıklarını etkinleştirmek veya devreden çıkarmak için,  düğmesine basın.

Visit linksys.com/support for award-winning technical support



Cisco, the Cisco logo, Flip, and Linksys are trademarks or registered trademarks of Cisco and/or its affiliates in the United States and other countries. A listing of Cisco's trademarks can be found at www.cisco.com/go/trademarks. All other trademarks mentioned in this document are the property of their respective owners.

© 2011 Cisco and/or its affiliates. All rights reserved.

3425-01528